

FOR LEASE

UNIT 125, 1725 - 32 AVENUE NE
CALGARY, AB

INDUSTRIAL-COMMERCIAL UNIT



PROPERTY HIGHLIGHTS

- Size: $\pm 3,161$ sq.ft.
- Basic Rent: \$14.09/sq.ft./year
- 2016 Operating Costs:
Operating Budget: \$4.74/sq.ft./year
Property Taxes: \$2.15/sq.ft./year
TOTAL: \$6.89/sq.ft./year
- Zoning: I-C (Industrial Commercial)
- Drive-thru loading, previously used as an automotive service shop.
- Small showroom, office, two washrooms, with mezzanine above.
- Available pylon signage fronting 32 Avenue.
- Located within a busy complex with a variety of commercial uses.

FOR MORE INFORMATION PLEASE CONTACT:

GRANT SCHELL

T 403.701.4273

E gschell@schellbrothers.ca

MARK SCHELL

T 403.861.1143

E mschell@schellbrothers.ca



The information is intended for informational purpose only and should not be relied upon by recipients hereof. Schell Brothers Real Estate Corp. neither guarantees, warrants or assumes any responsibility or liability with respect to the accuracy, correctness, completeness, or suitability of, or decisions based upon or in connection with, the information. The information may change and any property described herein may be withdrawn from the market at any time without notice or obligation of any kind on the part of Schell Brothers Real Estate Corp.

FOR LEASE

INDUSTRIAL-COMMERCIAL UNIT

UNIT 125, 1725 - 32 AVENUE NE
CALGARY, AB

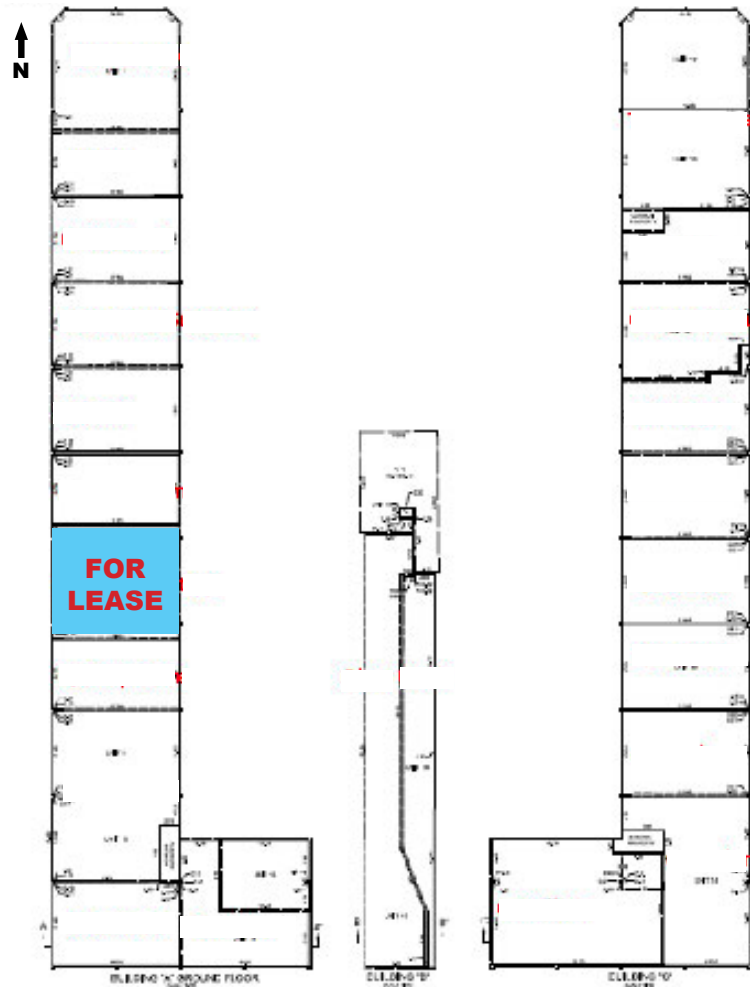

FOR MORE INFORMATION PLEASE CONTACT:

GRANT SCHELL

T 403.701.4273

E gschell@schellbrothers.ca

MARK SCHELL

T 403.861.1143

E mschell@schellbrothers.ca



The information is intended for informational purpose only and should not be relied upon by recipients hereof. Schell Brothers Real Estate Corp. neither guarantees, warrants or assumes any responsibility or liability with respect to the accuracy, correctness, completeness, or suitability of, or decisions based upon or in connection with, the information. The Information may change and any property described herein may be withdrawn from the market at any time without notice or obligation of any kind on the part of Schell Brothers Real Estate Corp.